

Participation

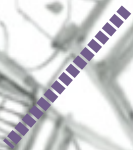

Giacomo [Italy], Megan [Great Britain], Claudia [Italy], Charl [Netherlands], Amandine [Belgium]



LIE
GE



SERAING









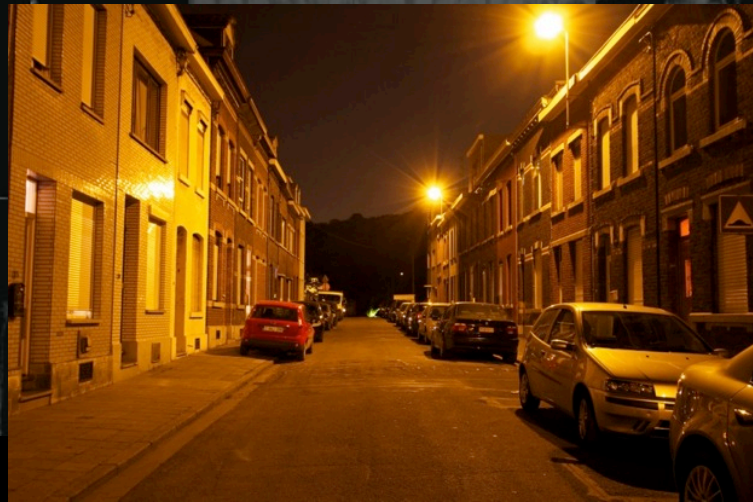
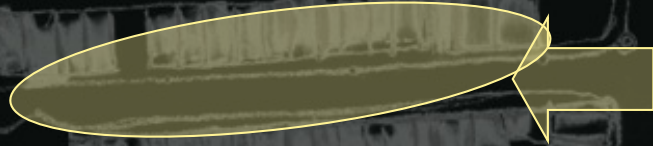

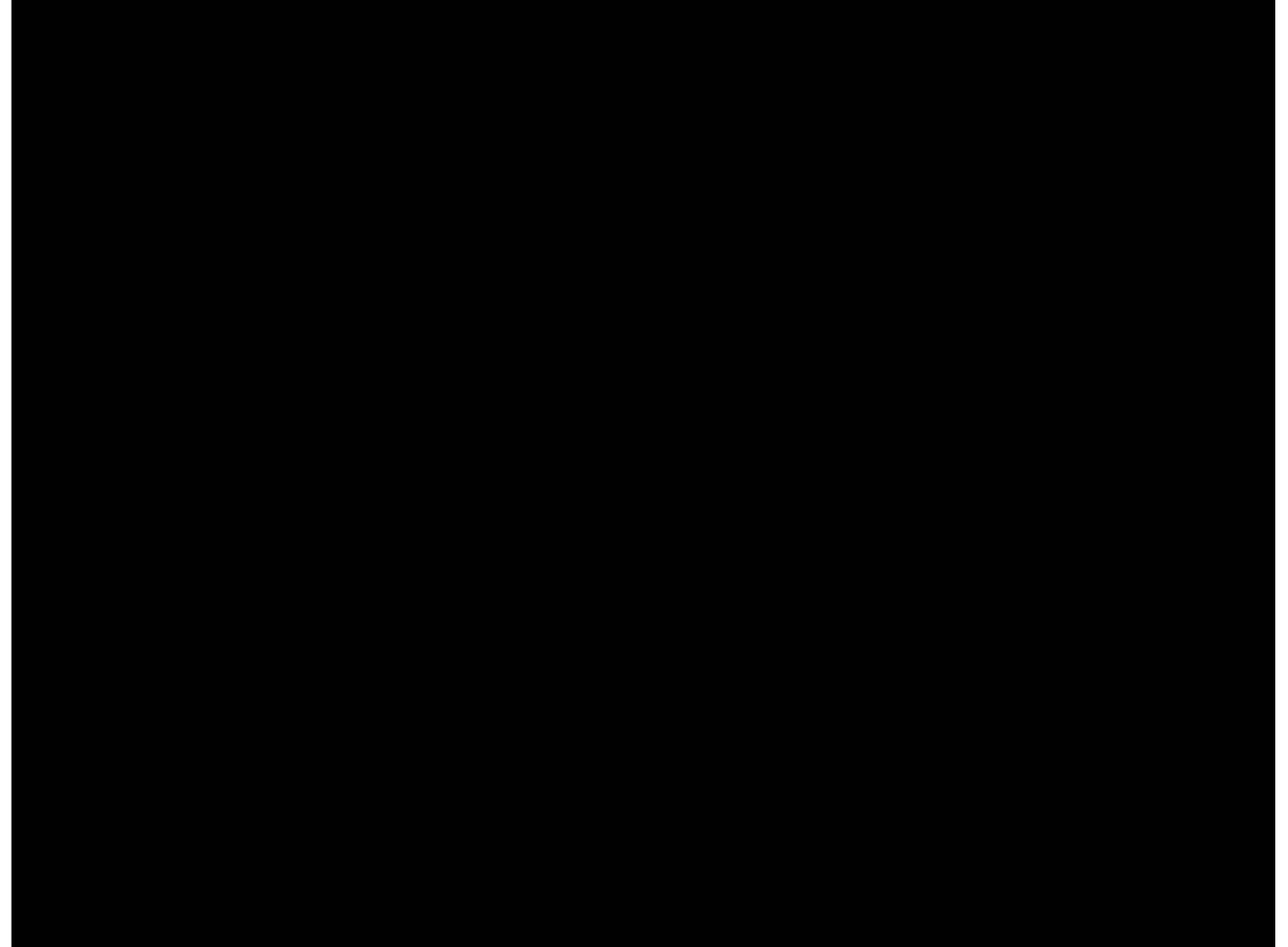



The people **LOVE** the park and use it

**BU
T**

They are scared of the idea
of people hiding in the
shadows

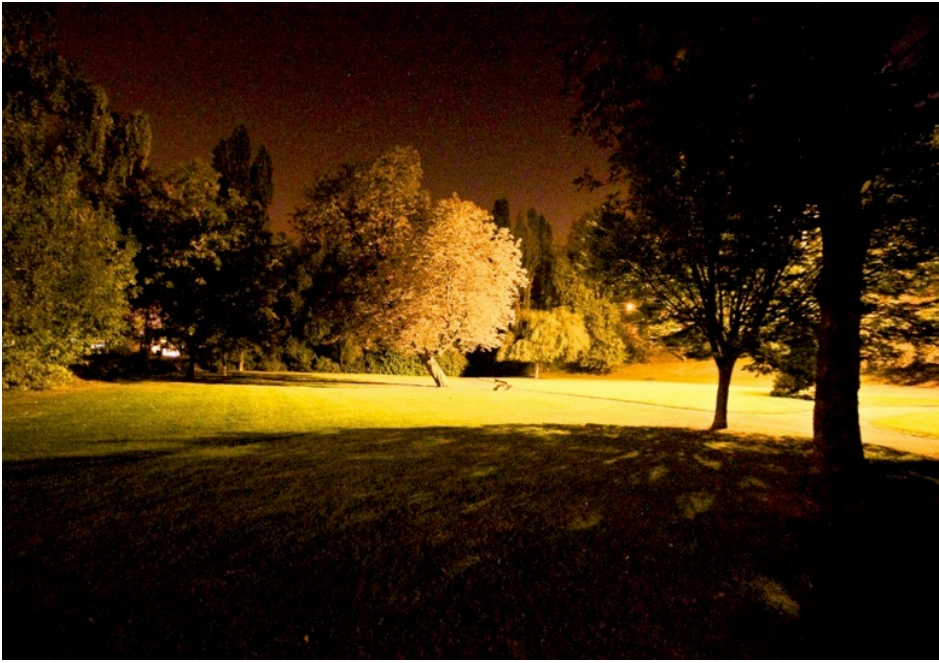

The **AMOUNT** of light into a park is very high

**BU
T**

It is **NOT WELL
DISTRIBUTED** or
CONTROLLED



We want the people to be able to enjoy the park at night



We want to create a space where people can share experiences

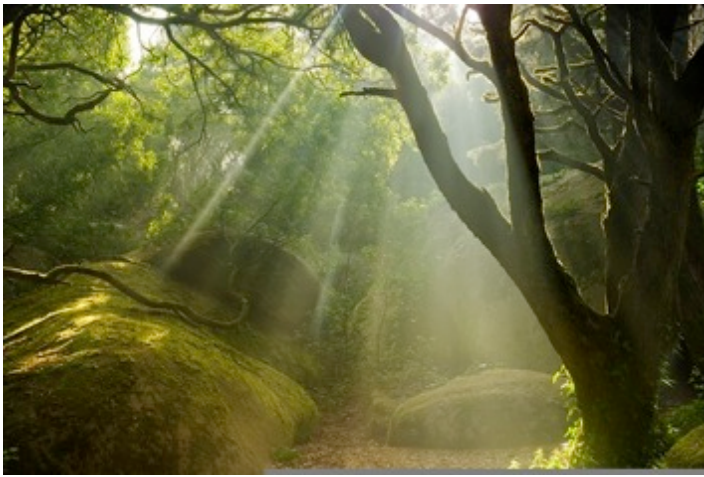

We can do this by using light in a very simple and sustainable way

We want to have

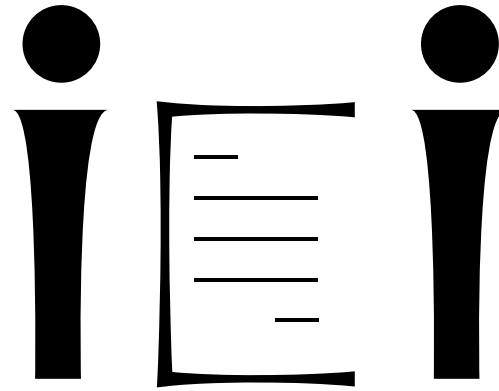

Participation

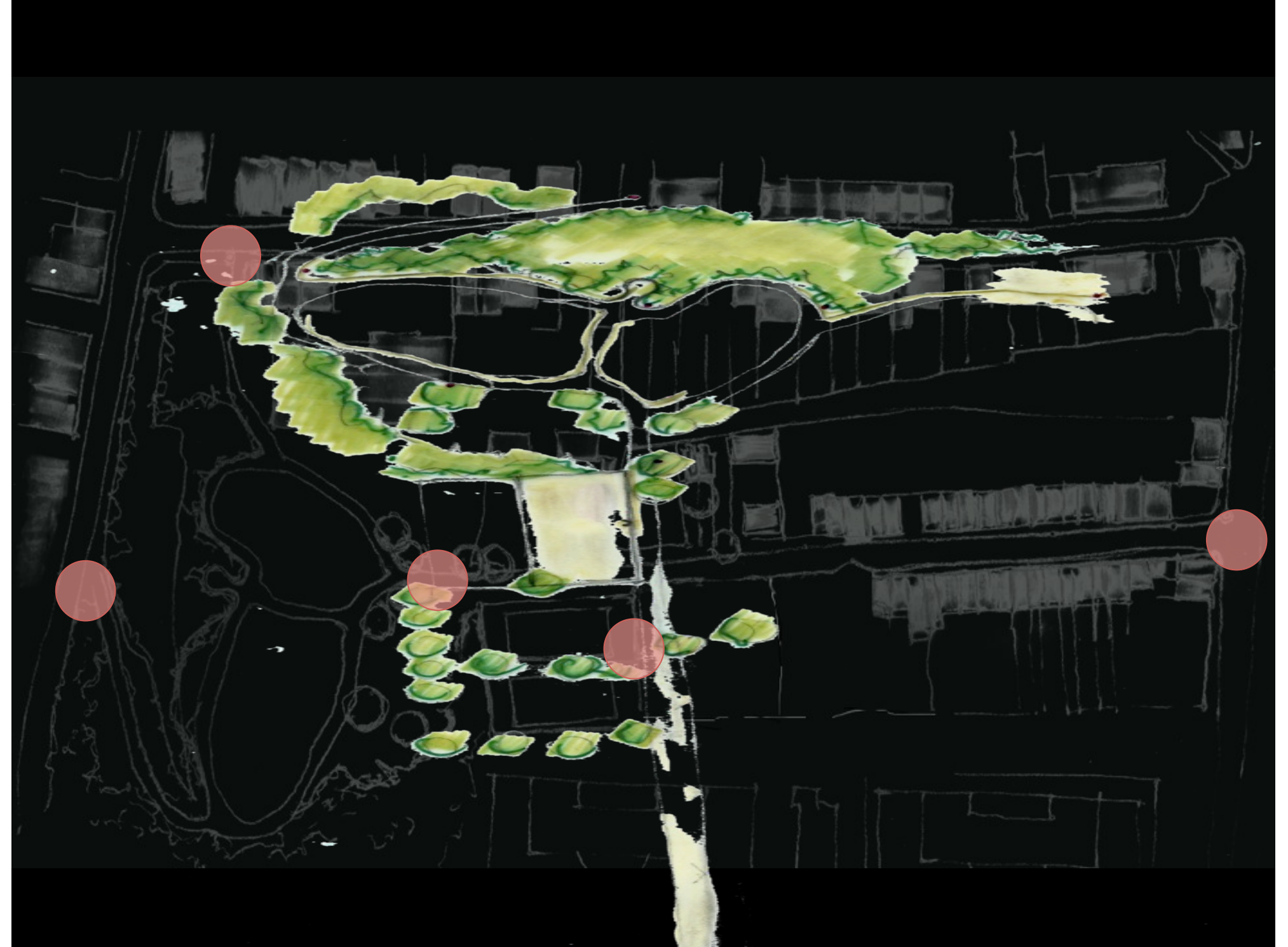



Street



Street entrance



Main entrance

Second entrance



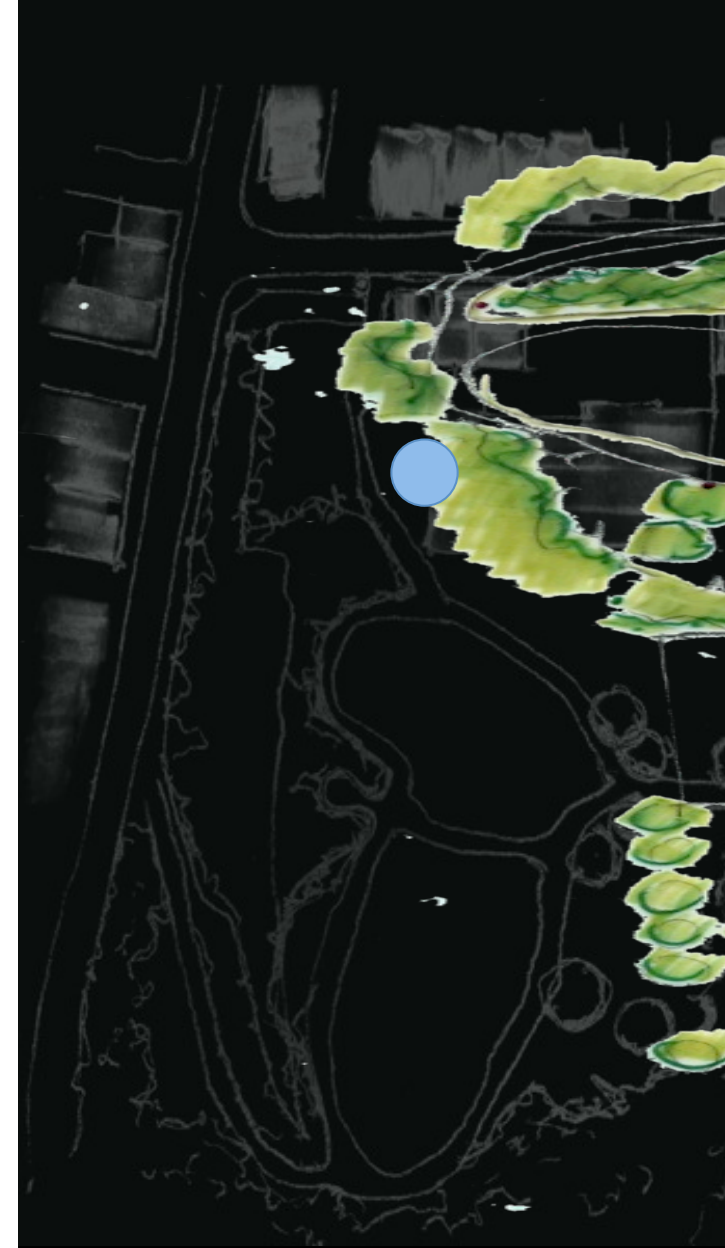

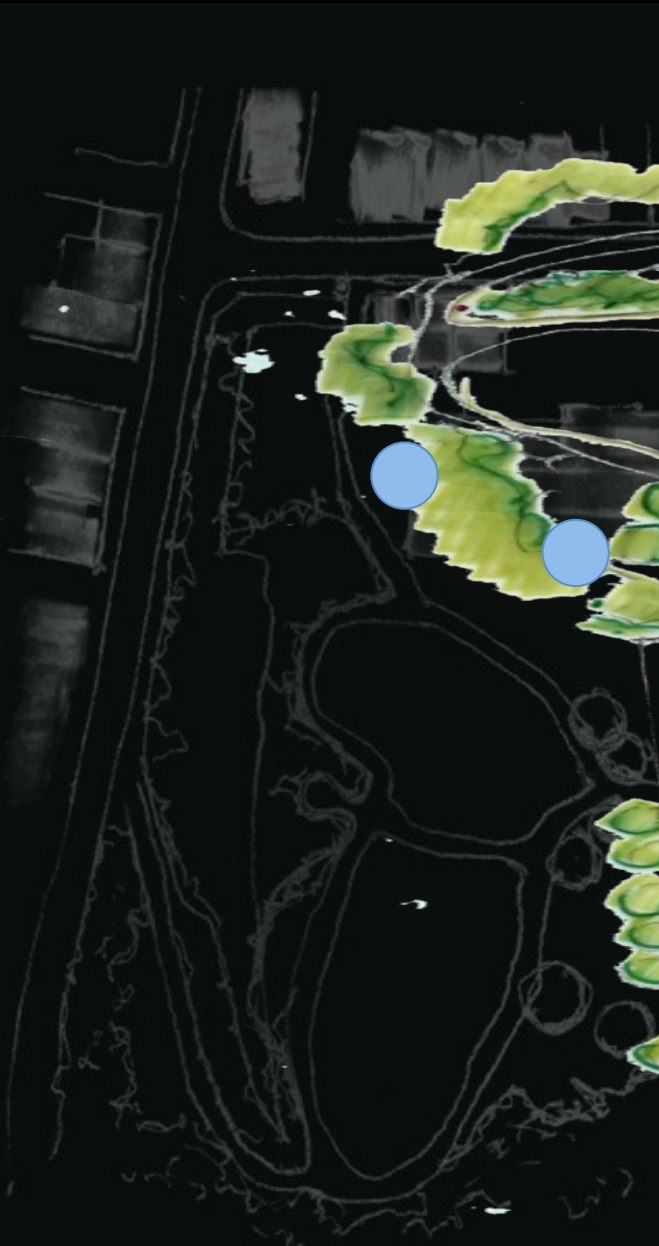

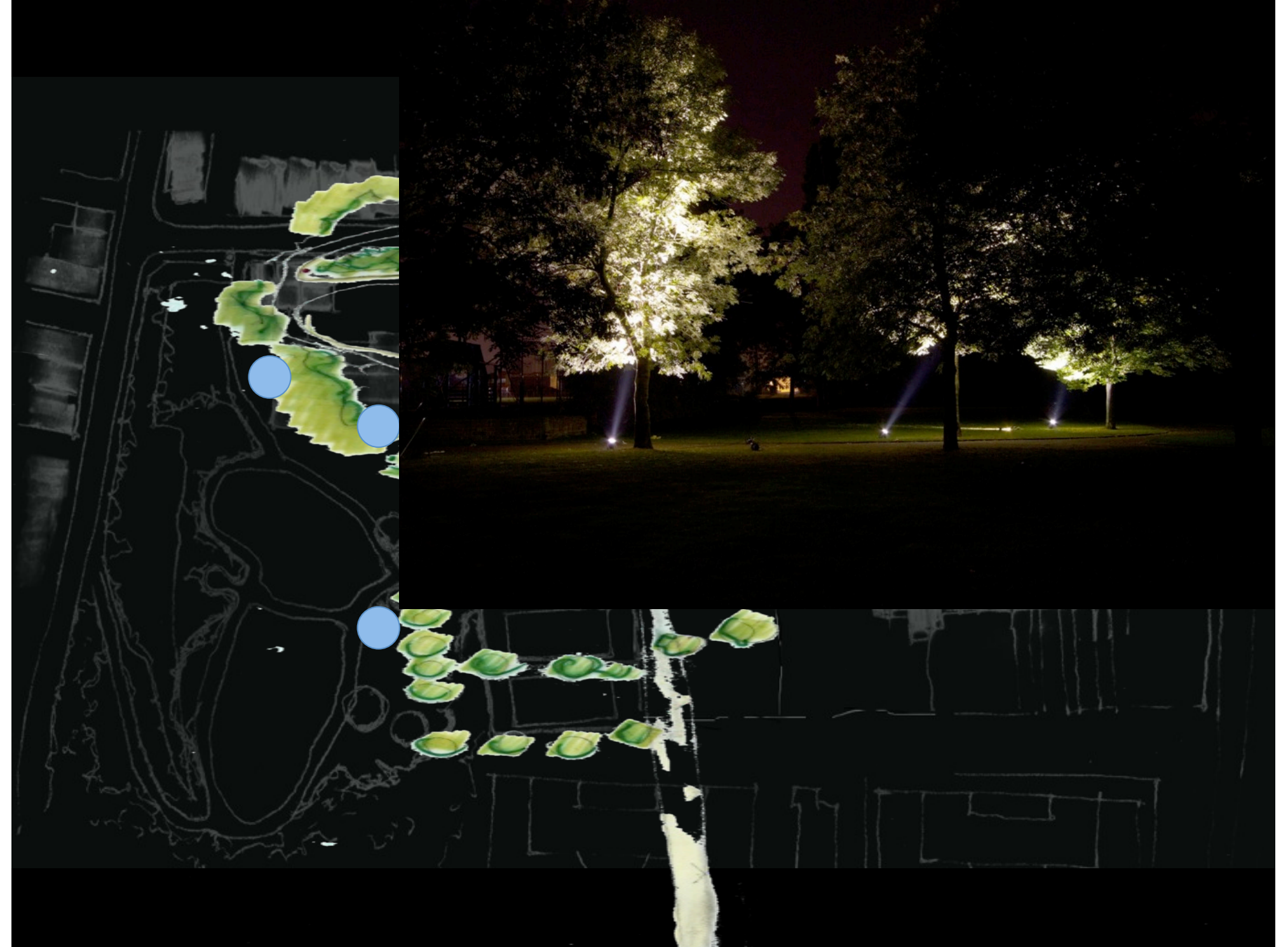

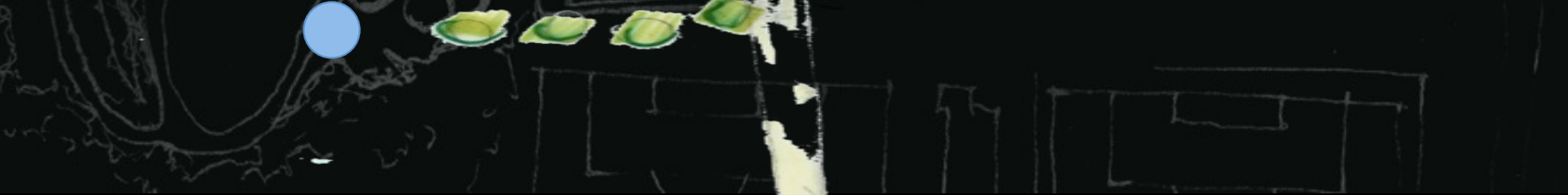

Participate is

Enabling people to enjoy the park into the night.

Give people confidence by providing a well lit space, while allowing darker (but not dark) areas for relaxation.

Using and complementing existing features of the park using simple methods that redefine the area after dark and provide new opportunities for interaction.

Providing a safe environment for children to play after dark.

and also...

Participate is

a SWITCH

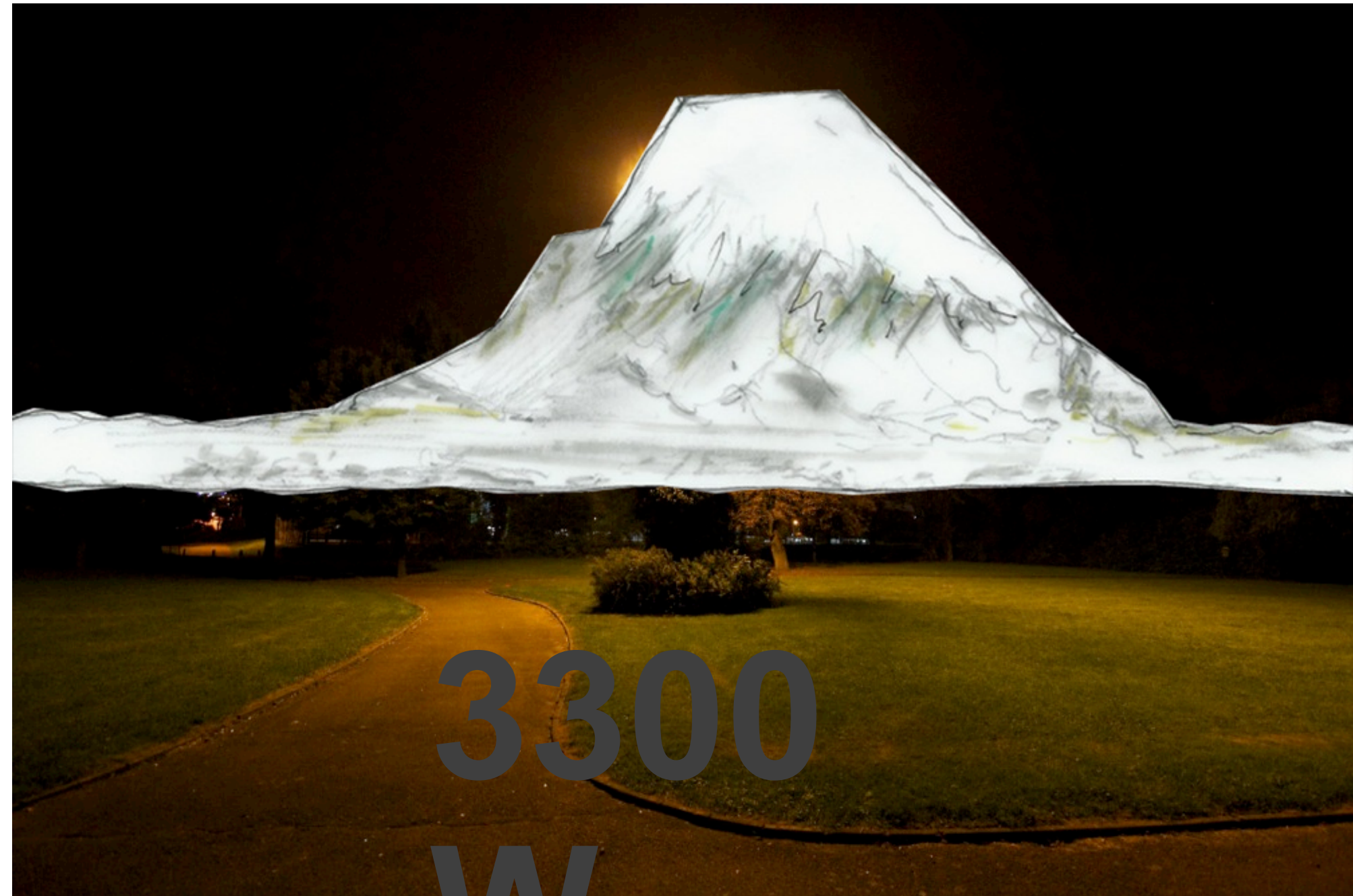

3300

W



50%
Energy

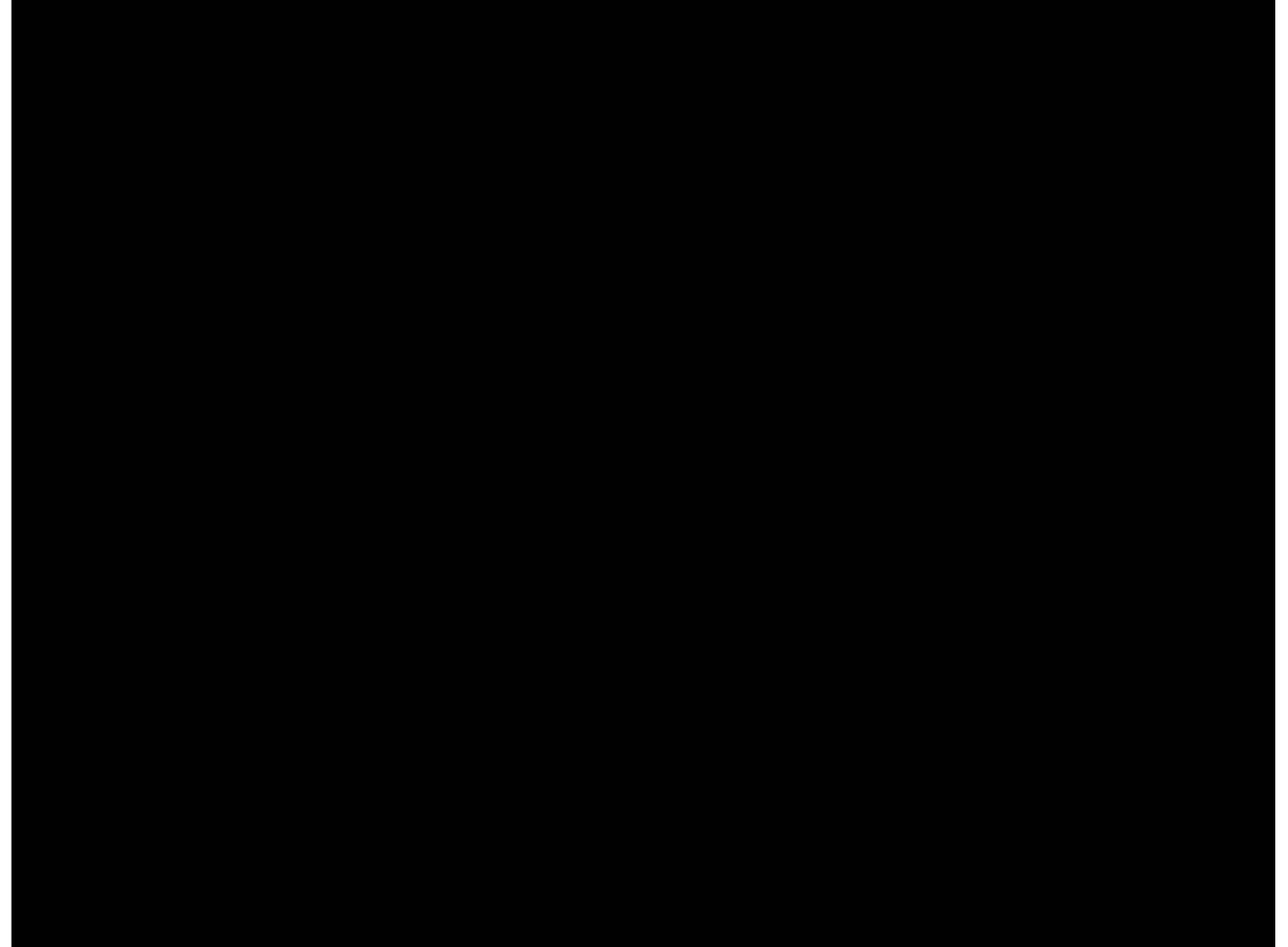

Participation



Thanks